

3/4" EXTERIOR PLYWOOD FLOORING

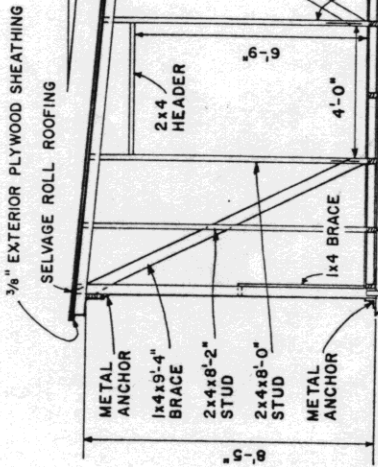

2x4x12'-0" JOIST, FASTEN TO SKID WITH FRAMING ANCHOR, METAL STRAPS OR 3/4" B BOLTS

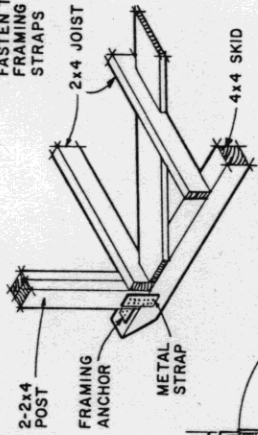

2x4x7'-8" STUD

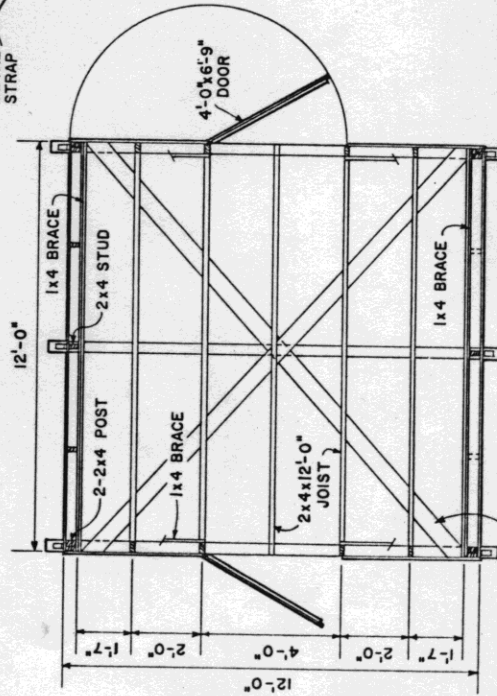
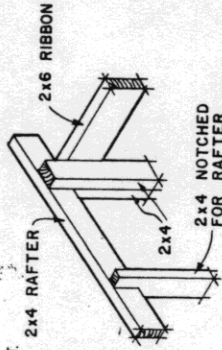

1x6x16'-3" X-BRACE NOTCH INTO TOP OF SKIDS

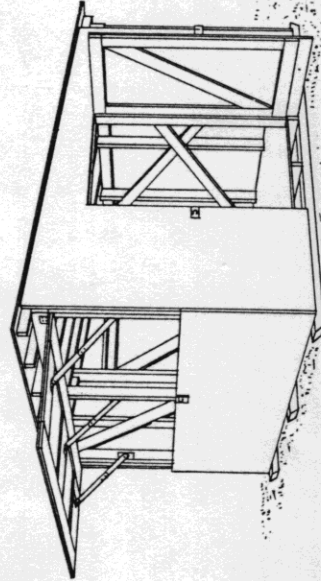

NOTES:
3/8" EXTERIOR PLYWOOD, ALUMINUM, OR GALVANIZED SHEET METAL MAY BE USED FOR SIDING.
SKIDS, JOISTS, X-BRACING, BOTTOM PART OF POSTS AND STUDS TO BE TREATED WITH PRESERVATIVE SUCH AS CREOSOTE OR PENTACHLOROPHENOL.